

USED ON
--

D
C
B
A

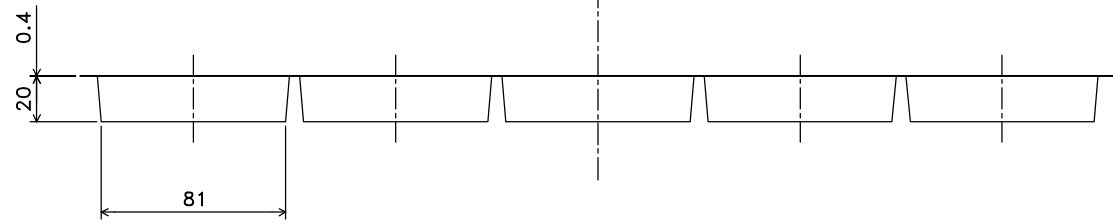
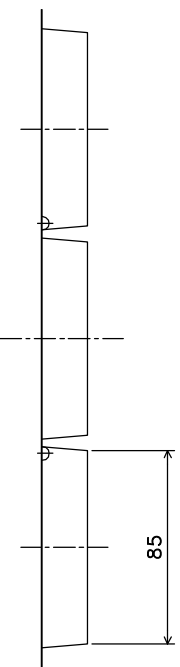
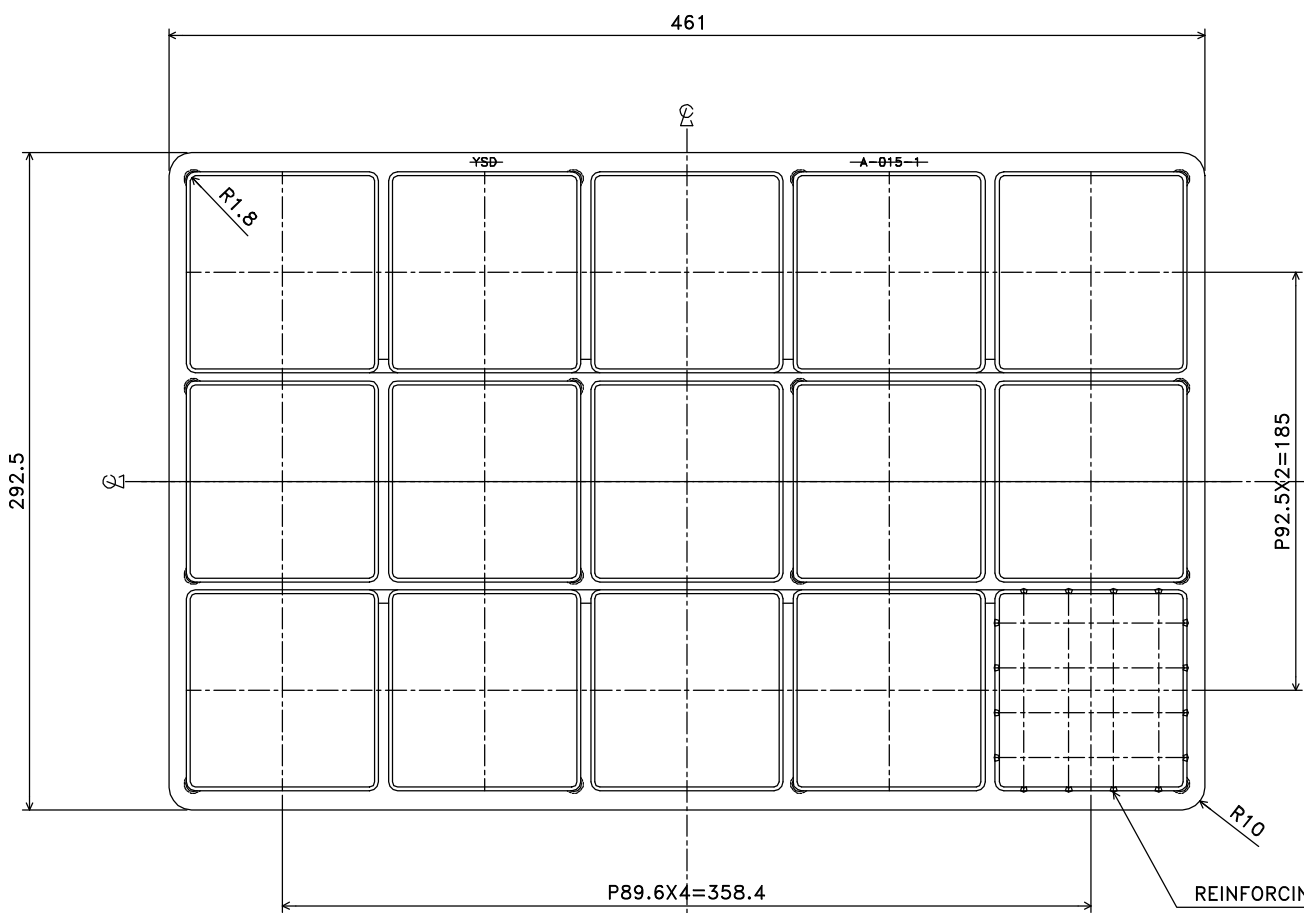

- NOTES
- 1.GENERAL TOLERANCE,±0.5
 - 2.MATERIAL,PS0.4t(COLOR,NATURAL)
 - 3.DRAFT ANGLE,5° MAX, TYP.
 - 4.INDICATE THE P/N(5m/m CHARACTER SIZE)

LDC
DIST

DNV	27 JULY 1999	MATERIAL	HEAT TREAT
CHK	27 JULY 1999	YOSHIDA PACKAGE CO.,LTD KAWASAKI, JAPAN	
APV	27 JULY 1999		
Jr. YOSHIDA		(Product Drawing)	
TRAY FOR 15 POCKETS			
SCALE	SIZE	DRAWING NO	SHEET
	A3	YSD A-015-1	1 OF 1
			REV
			0

8 | 7 | 6 | 5 | 4 | 3 | 2 | 1